

# Sliding Door System Quote Request/ Order Form

Request for: ☐ Quote ☐ Order

Company: \_\_\_\_\_  
 Contact Name: \_\_\_\_\_  
 Address: \_\_\_\_\_  
 City, State, Zip: \_\_\_\_\_  
 Phone #: \_\_\_\_\_  
 Fax #: \_\_\_\_\_  
 Email: \_\_\_\_\_

Fax form to: 704-332-3267 or email to:  
 orders@element-designs.com



Ph: (877)332-3396 Fx:(704)332-3267  
 www.element-designs.com info@element-designs.com

Date: \_\_\_\_\_  
 PO Number (if applies): \_\_\_\_\_  
 Project Name: \_\_\_\_\_

## ① Profile Type (choose one)

- ☐ AF001\* ☐ AF002  
☐ AF003 ☐ AF004  
☐ AF005 ☐ AF006\*\*  
☐ AF007 ☐ AF008\*  
☐ AF009\*\*\* ☐ AF010\*\*\*\*

\* AF001/ AF008 with AL1540/ AL1524/ SH 7035 ONLY  
 \*\* AF006 available with opaque acrylic inserts only  
 \*\*\* AF009 made with 6mm inserts contact Element Designs for insert options  
 \*\*\*\* AF010 available with backpainted glass inserts only

## ② Profile Finish (choose one)

- Anodized Finish**  
☐ Natural Anodized  
☐ Brushed Stainless Steel  
**Powdercoat Finish**  
☐ Oil Rubbed Bronze  
☐ White ☐ Black

## ③ Insert Type (choose one) all glass inserts are tempered

### Standard Insert Options

- ☐ Satin Glass (acid etched) ☐ Masterpoint Glass  
☐ Clear Glass ☐ Austral Glass  
☐ Master Carre Glass ☐ Platinum Ice Acrylic  
☐ Reeded Glass\*

### Backpainted Glass Inserts:

- ☐ White ☐ Charcoal  
☐ Black ☐ Sand  
☐ Custom Color\*: \_\_\_\_\_ \*color match fee applies

**Painted Glass Finish:** (select one) ☐ Gloss ☐ Matte

☐ 3Form Inserts\*: Pattern: \_\_\_\_\_

☐ PARAPAN: Color: \_\_\_\_\_ Code: \_\_\_\_\_

☐ Metal Laminate Inserts: ☐ Aluminum ☐ Stainless\*

☐ Zenolite® Inserts: Color: \_\_\_\_\_

☐ No Insert

inserts are 5/32" (4mm) thick (inserts for AF009 are 1/4" (6mm) thick)  
 \*Directional pattern for reeded glass, select 3Form and stainless laminate inserts: \_\_\_\_\_ [vertical (standard) or horizontal]

## ⑤ Sliding Hardware System (choose one)

**See technical manual for hardware specifications**

### ☐ CD 40 CX Large Door Floor Sliding System

Carrier Kit Qty: \_\_\_\_\_ (1 per door)  
 Top Guide Length: \_\_\_\_\_ in. (1 per door)  
 Select One: ☐ Inset OR ☐ Surface Mount  
 Track Length: \_\_\_\_\_ in. (1 per door) OR  
 Double Track Length: \_\_\_\_\_ in. **Surface Mount Only**  
 (1 per 2 doors)

### ☐ CA 4585 Large Door Top Sliding System

Carrier Kit Qty: \_\_\_\_\_ (1 per 2 doors)  
 Top Track Length: \_\_\_\_\_ in. (1 per 2 doors)

### ☐ CD 50 TOP Large Door Top Sliding System

Carrier Kit (internal door) Qty: \_\_\_\_\_ (1 per door)  
 Carrier Kit (external door) Qty: \_\_\_\_\_ (1 per door)  
 Top Track Length: \_\_\_\_\_ in. (1 per 2 doors)  
 Bottom Guide Length: \_\_\_\_\_ in. (1 per 2 doors)  
 Include Easy Soft CD 50: ☐ yes ☐ no

### ☐ PL 2550 Large Door Bi-Fold Sliding System

Carrier Kit Qty: \_\_\_\_\_ (1 per 2 folding doors)  
 Guide Length: \_\_\_\_\_ in. (1 per 2 doors)  
 Opens: ☐ LEFT ☐ RIGHT

### ☐ AL 1540 Small Door Sliding System

Carrier Kit Qty: \_\_\_\_\_ (1 per door)  
 Select One: ☐ Inset OR ☐ Overlay  
 Track Length: \_\_\_\_\_ in.  
 Fascia Length: \_\_\_\_\_ in. **Overlay Only**

### ☐ SH 7035 Small Door Sliding System

Carrier Kit Qty: \_\_\_\_\_ (1 per door)  
 Top & Bottom Track Length: \_\_\_\_\_ in.

## ⑥ Knobs/ Pulls

- ☐ Part #: \_\_\_\_\_ ☐ no handle holes  
☐ Qty: \_\_\_\_\_ ☐ other handles-drill handle holes (pg 2)

OR

## ③ PARAPAN® 18mm High Gloss Solid Surface Doors:

☐ PARAPAN Color: \_\_\_\_\_ Code: \_\_\_\_\_ Edge Radius: \_\_\_\_\_

## ④ Box/ Cabinet Construction

**Inside Box/ Cabinet Opening:** **Outside Box/ Cabinet:** **Box/ Cabinet Wall Thickness:**  
 Height (Left): \_\_\_\_\_ Height (Left): \_\_\_\_\_ Top: \_\_\_\_\_  
 Height (Center): \_\_\_\_\_ Height (Center): \_\_\_\_\_ Side: \_\_\_\_\_  
 Height (Right): \_\_\_\_\_ Height (Right): \_\_\_\_\_ Bottom: \_\_\_\_\_  
 Width: \_\_\_\_\_ Width: \_\_\_\_\_

### Toe kick:

Height: \_\_\_\_\_ **Center Stile Visibility:** ☐ Single (doors overlay) ☐ Double  
 Depth from front of cabinet: \_\_\_\_\_ **Door Overlay:** \_\_\_\_\_ (if applicable)

Item	Quantity	Sliding Door Dimensions (see page 2)		Divider Rails (see page 3)	Divider Rail Qty	in/mm	Distributor Use Only	
		Width	Height				Price	Ext. Price
1				<input type="checkbox"/> yes <input type="checkbox"/> no				
2				<input type="checkbox"/> yes <input type="checkbox"/> no				
3				<input type="checkbox"/> yes <input type="checkbox"/> no				

**Contact Element Designs for sliding door systems with more than 2 doors and/ or additional sliding door hardware options.**

Special Instructions:

Knobs/ Pulls	
Hardware	
Shipping	
<b>Total</b>	

## Sliding Door Size Calculations

Element Designs will determine proper hardware locations based on your sliding door application. All doors ship fully assembled with hardware pre-attached (when possible), tracks and guides cut to size and arrive ready to install.

	Width Calculation	Height Calculation	Components Included	Dimensions Needed	Pre-Installed Hardware	Application Type(s)	Additional Information
CD 40 CX Floor Sliding	Inside Cabinet Width/2 + 1/2 Door Profile Width*(1 center stile visible) or Inside Cabinet Width/ 2 (2 center stiles visible)	Inside Cabinet or Opening Height - 38mm (surface mounted floor track) or Inside Cabinet or Opening Height - 33mm (inset floor track)	Carriers Top Guide Bottom Track	Inside Cabinet or Opening	Top Carrier & Bottom Guide	Inside Cabinet (Inset Application) or Floor to Ceiling	
CD 4585 Top Sliding	Inside Cabinet Width/ 2 + 1/2 Door Profile Width*	Floor to Inside Cabinet/Opening Height - 48mm	Carriers Top Track Floor Guides	Inside Cabinet or Opening	Doors Bored for Top Carrier (Customer Installs Top Carrier)	Inside Cabinet (Inset Application) or Floor to Ceiling	
CD 50 TOP Top Sliding	Outside Cabinet Width/ 2 + 1/2 Door Profile Width*	Outside Height + 95mm	Exterior & Interior Door Carriers Top Track Bottom Guide	Inside Cabinet & Outside Cabinet	Customer Installs Carriers	Cabinet Only (Overlay Application)	Toe kick must be greater or equal to 3 3/8" (86mm)
PL 2550 Bi-Fold	Outside Cabinet Width/ 2	Outside Height	Carriers Euro Hinges Bottom Guide	Inside Cabinet & Outside Cabinet	Pre-drilled for Hinges Bi-Fold & Roller Hardware Installed	Cabinet Only (Overlay Application)	Customer can substitute Element Designs supplied soft close hinges
AL 1540	Inset: Inside Cabinet Width/ 2 + 1/2 Door Profile Width*	Inset: Inside Cabinet Height - 5mm or Overlay: Outside cabinet height	Carriers Track Fascia (Overlay Only)	Inside Cabinet Outside Cabinet for Overlay Applications	Top & Bottom Carriers	Cabinet Only (Overlay or Inset Application)	Track is surface mounted in overlay application
SH 7035	Inset: Inside Cabinet Width/ 2 + 1/2 Door Profile Width*	Inside Cabinet Height - 6mm	Top and Bottom Rollers Top and Bottom Track	Inside Cabinet	Top and Bottom Rollers	Cabinet Only (Inset Application Only)	

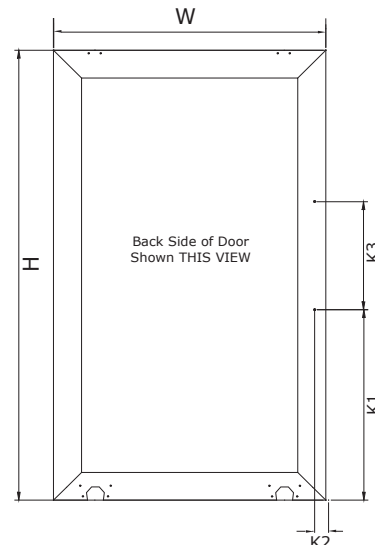
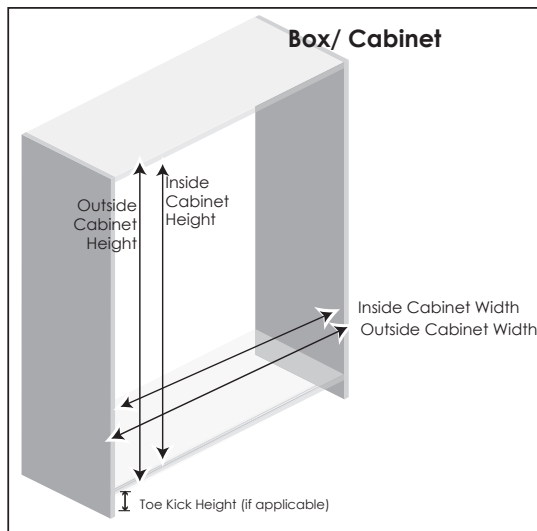

### Handle Borings

K1 = \_\_\_\_\_ (Knob or Pull)  
(Min = 2 1/4") (Std = 2 1/2")

K2 = \_\_\_\_\_ (Knob or Pull)  
(Std = centered on frame)

K3 = \_\_\_\_\_ (Pull only)  
(center to center distance)

Handle Hole Diameter = 11/64"

Technical Specifications Subject to Change

### \* Door Profile Width

AF001 = 3/4" (19mm)

AF002 = 2 1/8" (54mm)

AF003 = 2 1/8" (54mm)

AF004 = 1 3/4" (45mm)

AF005 = 1 3/4" (45mm)

AF006 = 1 3/4" (45mm)

AF007 = 2 3/4" (70mm)

AF008 = 3/4" (19mm)

AF009 = 2 1/2" (63.5mm)

AF010 = 1 11/16" (42.8mm)

For single stile to be visible at cabinet center: inside cabinet width/ 2 + 1/2 profile width

For both stiles to be visible: cabinet width/ 2

for additional information or customer support  
please call: (877) 332-3396

## Divider Rail Specification Page

<div style="border: 2px solid gray; padding: 10px; text-align: center; height: 170px;">Panel 1</div>	<div style="border-top: 1px solid black; border-bottom: 1px solid black; height: 170px; position: relative;"> <div style="position: absolute; top: 0; bottom: 0; left: 0; right: 0; border-left: 1px solid black; border-right: 1px solid black;"></div> </div>	<p><b>D1 =</b> _____</p> <p>(top of door to center of divider rail)</p> <p><b>Panel 1 insert type:</b> _____</p>
<div style="border: 2px solid gray; padding: 10px; text-align: center; height: 170px;">Panel 2</div>	<div style="border-top: 1px solid black; border-bottom: 1px solid black; height: 170px; position: relative;"> <div style="position: absolute; top: 0; bottom: 0; left: 0; right: 0; border-left: 1px solid black; border-right: 1px solid black;"></div> </div>	<p><b>D2 =</b> _____</p> <p>(center of divider rail to center of divider rail or bottom of door if applicable)</p> <p><b>Panel 2 insert type:</b> _____</p>
<div style="border: 2px solid gray; padding: 10px; text-align: center; height: 170px;">Panel 3</div>	<div style="border-top: 1px solid black; border-bottom: 1px solid black; height: 170px; position: relative;"> <div style="position: absolute; top: 0; bottom: 0; left: 0; right: 0; border-left: 1px solid black; border-right: 1px solid black;"></div> </div>	<p><b>D3 =</b> _____ <b>(if applicable)</b></p> <p>(center of divider rail to center of divider rail or bottom of door if applicable)</p> <p><b>Panel 3 insert type:</b> _____</p>
<div style="border: 2px solid gray; padding: 10px; text-align: center; height: 207px;">Panel 4</div>	<div style="border-top: 1px solid black; border-bottom: 1px solid black; height: 207px; position: relative;"> <div style="position: absolute; top: 0; bottom: 0; left: 0; right: 0; border-left: 1px solid black; border-right: 1px solid black;"></div> </div>	<p><b>D4 =</b> _____ <b>(if applicable)</b></p> <p>(center of divider rail to center of divider rail or bottom of door if applicable)</p> <p><b>Panel 4 insert type:</b> _____</p>